



AKAI

**CAR TFT LCD
COLOR TV-SET**

Model:
ATF-957

SERVICE MANUAL

CONTENT

- 1. BILL OF MATERIAL.....3-6
- 2. EXPLORED VIEW.....7
- 3. PCB BOARD.....8-9
- 4. SCHEMATIC BIAGRAM.....10
- 5. BLOCK DIAGRAM.....11
- 6. SPECIFICATION.....12

PRELIMINARY BILL OF MATERIAL

NO.	PART NO.	DESCRIPTION	ACT	SPECIFICATION	QTY	REMARK
1	101-070287801210	PCB		TFT8-9(780)2007-05-31	1	
2	108-001803013000	CHIP RESISTOR	0603	4.7 Ω	2	
3	108-001803013000	CHIP RESISTOR	0603	18 Ω	2	
4	108-004703013000	CHIP RESISTOR	0603	47 Ω	2	
5	108-005603013000	CHIP RESISTOR	0603	56 Ω	4	
6	108-007503013000	CHIP RESISTOR	0603	75 Ω	1	
7	108-010103013000	CHIP RESISTOR	0603	100 Ω	25	
8	108-022103013000	CHIP RESISTOR	0603	220 Ω	1	
9	108-033103013000	CHIP RESISTOR	0603	330 Ω	5	
10	108-056103013000	CHIP RESISTOR	0603	560 Ω	5	

7	108-010103013000	CHIP RESISTOR	0603	100 Ω	25	
8	108-022103013000	CHIP RESISTOR	0603	220 Ω	1	
11	108-010203013000	CHIP RESISTOR	0603	1K	8	
12	108-022203013000	CHIP RESISTOR	0603	2.2K	2	
13	108-047203013000	CHIP RESISTOR	0603	4.7K	21	
14	108-056203013000	CHIP RESISTOR	0603	5.6K	1	
15	108-062203013000	CHIP RESISTOR	0603	6.2K	1	
16	108-082203013000	CHIP RESISTOR	0603	8.2K	2	
17	108-010303013000	CHIP RESISTOR	0603	10K	18	
18	108-015303013000	CHIP RESISTOR	0603	15K	1	
19	108-027303013000	CHIP RESISTOR	0603	27K	3	
20	108-030303013000	CHIP RESISTOR	0603	30K	3	
21	108-039303013000	CHIP RESISTOR	0603	39K	5	
22	108-047303013000	CHIP RESISTOR	0603	47K	2	
23	108-010403013000	CHIP RESISTOR	0603	100K	4	
24	108-010503013000	CHIP RESISTOR	0603	1M	1	
25		CHIP RESISTOR	R0805	22 Ω	1	
26	108-750330733200	RESISTOR	VR6-SM	50K	1	
27	109-302230730000	CHIP CAPACITANCE	0603	22P	2	
28	109-303330730000	CHIP CAPACITANCE	0603	33P	4	
29	109-304730730000	CHIP CAPACITANCE	0603	47P	2	
30	109-310130730000	CHIP CAPACITANCE	0603	100P	4	
31	109-322230730000	CHIP CAPACITANCE	0603	222P	2	
32	109-310330730000	CHIP CAPACITANCE	0603	103P	2	
33	109-310430730000	CHIP CAPACITANCE	0603	104P	70	
34	109-747430704100	CHIP CAPACITANCE	0603	474P	4	

7	108-010103013000	CHIP RESISTOR	0603	100 Ω	25	
8	108-022103013000	CHIP RESISTOR	0603	220 Ω	1	
35	109-710530704100	CHIP CAPACITANCE	C0603	105P	5	
36		CHIP CAPACITANCE	C0805	105P	6	
37		CHIP CAPACITANCE	C0805	475P	1	
38	109-710630404100	CAPACITANCE	4*5mm	10UF/16V	7	
39	109-710630504100	CAPACITANCE	6*5mm	10UF/25V	3	
40	109-747630404100	CAPACITANCE	6*5mm	47UF/16V	3	
41	109-710730414100	CAPACITANCE	6*5mm	100UF/16V	5	
42		CAPACITANCE	6*5mm	100UF/25V	1	
44	109-733730321000	CAPACITANCE	8*7mm	330UF/16V	6	
45	112-303900060100	INDUCTANCE	L1210	39UH	1	
46	112-301000060100	INDUCTANCE	L1210	10UH	2	
47	112-300220060100	INDUCTANCE	L1210	2.2UH	1	
48		INDUCTANCE	L-HV/8*6MM	47UH/1A	2	
49	112-304710212200	INDUCTANCE	CD-1054	47UH/1A	1	
50	112-210139003100	INDUCTANCE	L-HV/8*6MM	100UH/1A	1	
51	114-007500030100	INDUCTANCE	L0603	75 Ω (BEND)	9	
52	106-558220000000	Chip diode	B320	IN5822	2	
53	106-403900104000	Chip diode	SMD	3.9V	1	
54	106-412000104000	Chip diode	SMD	12V	1	
55	107-02301002200	Chip Triode	SOT23-A	AF2301P	1	
56		Chip Triode	SOT23-A	2N3904	2	
57	107-018150002200	Chip Triode	SOT23-A	2SC1815C	7	
58	106-501580002000	Chip Triode	SOT23-A	BAV99	6	
59	111-061200021000	crystal flap	XTAL1	12.000M	1	
60	103-224080000000	IC	SOP-8	24C16	1	
61	103-240520000000	IC	SOP-16	4052	1	
62	103-215090000000	IC	SOP-8	ACT4060	2	
63	103-211173300000	IC	G950 T63U	GM1117-3.3V	1	
64	103-278012800000	IC	QFP128-1420	HTV780-128	1	
65	103-238600000000	IC	SOP-8	APA6822	1	
66	103-225100000000	IC	SOP-8	M25P10	1	
67	103-234140000000	IC	SOP-8	NJM3414A	1	
68		EARPHONE JACK		EJ3507-02	1	
69		DC JACK		DC-005B	1	

7	108-010103013000	CHIP RESISTOR	0603	100 Ω	25	
8	108-022103013000	CHIP RESISTOR	0603	220 Ω	1	
70		JACK		EJ-3536	3	
71	126-126050101000	JACK	SOP-26	30P)	1	
72	105-605000000060	tuning	XF-6A	PAL	1	
73		JACK			2	
74	126-004200010000	JACK			1	
75		JACK			1	
76	126-900043520040	JACK			1	
77	140-703000100301	WIRE			4	
78	140-000261006000	WIRE	100MM		2	
79		front carapace		ABS	1	
80		back carapace		ABS	1	
81		bracket base		ABS	1	
82		keystoke		ABS	1	
83		LENS			1	
84		screen		8?9	1	
85		ANTENNA		? 8.0*L 150 (1	
86		wire			1	
87		Detachable battery compartment stand			1	

EXPLORED VIEW.

A3

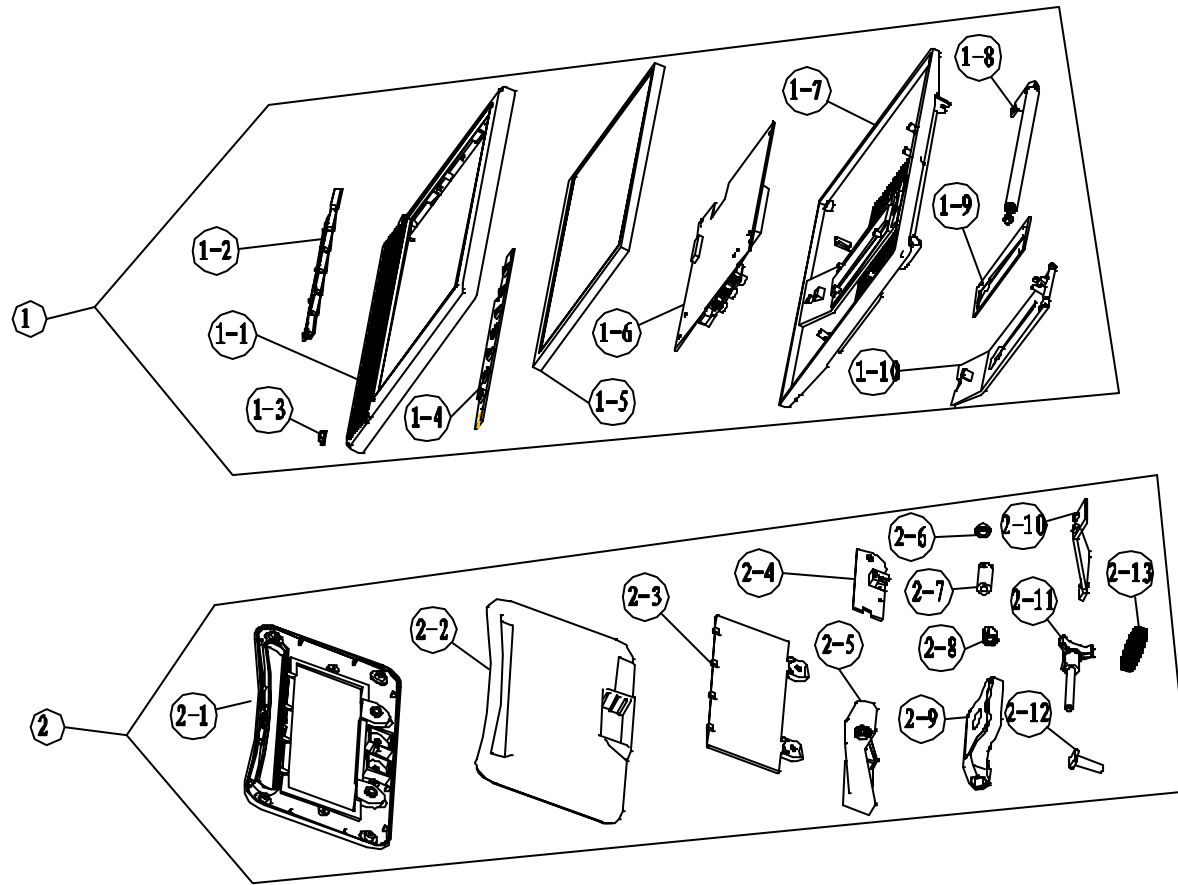

2-13	Plastic knob	
2-12	copper screw	
2-11	bracket axes	
2-10	Bracket Underside	
2-9	Stator	
2-8	Axes	
2-7	Latern ring	
2-6	Nut	
2-5	Bracket Panel	
2-4	PCB	
2-3	Casing	
2-2	Underside	
2-1	Panel	
2	Battery box	
1-10	Bracket	
1-9	Fastener	
1-8	Antenna	
1-7	black panel	
1-6	PCB	
1-5	9" screen	
1-4	KEY-PCB	
1-3	Lens	
1-2	buffon	
1-1	panel	
1	Display	
NO.	PART	Q

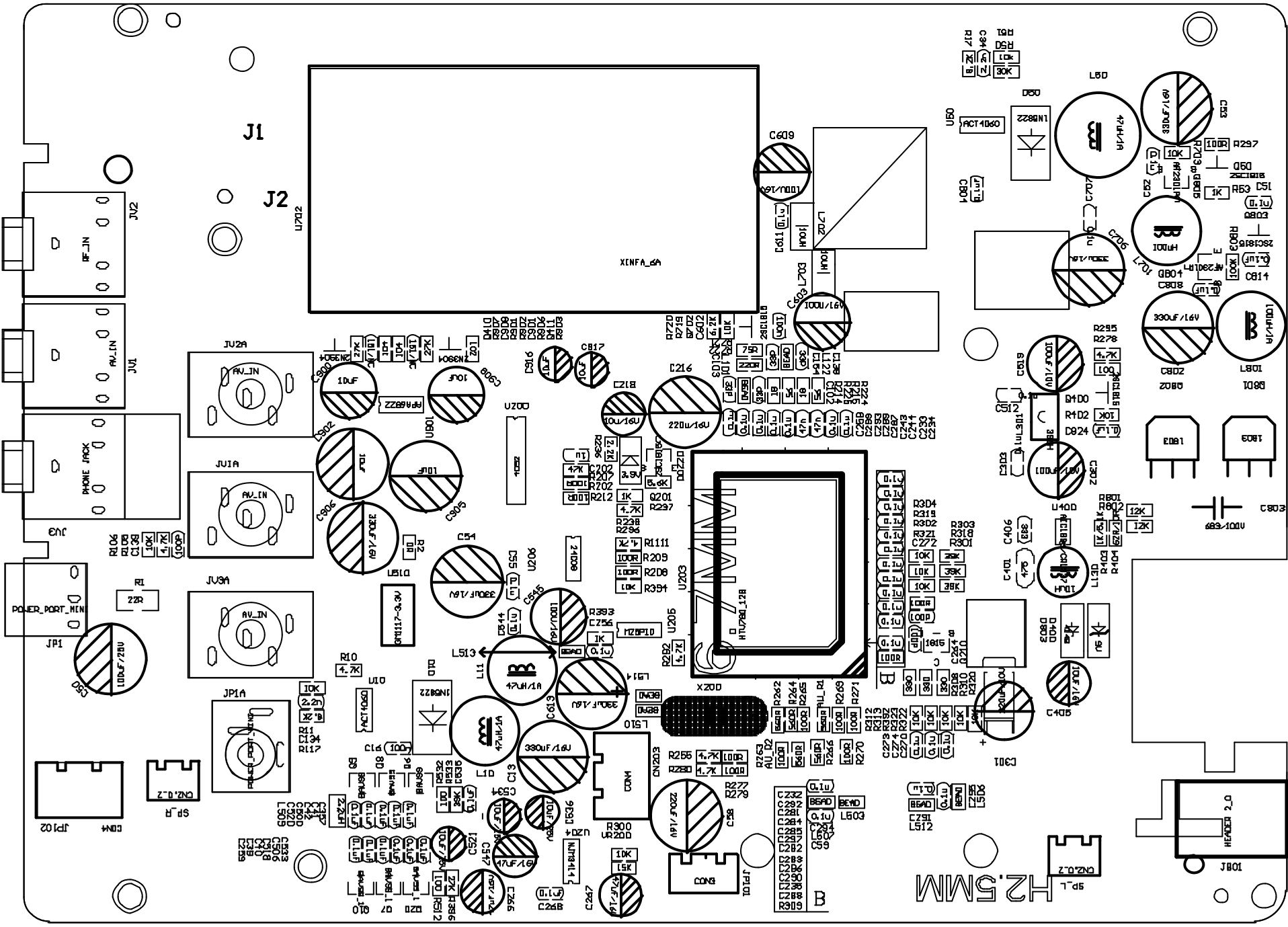

SCHEMATIC BIAGRAM

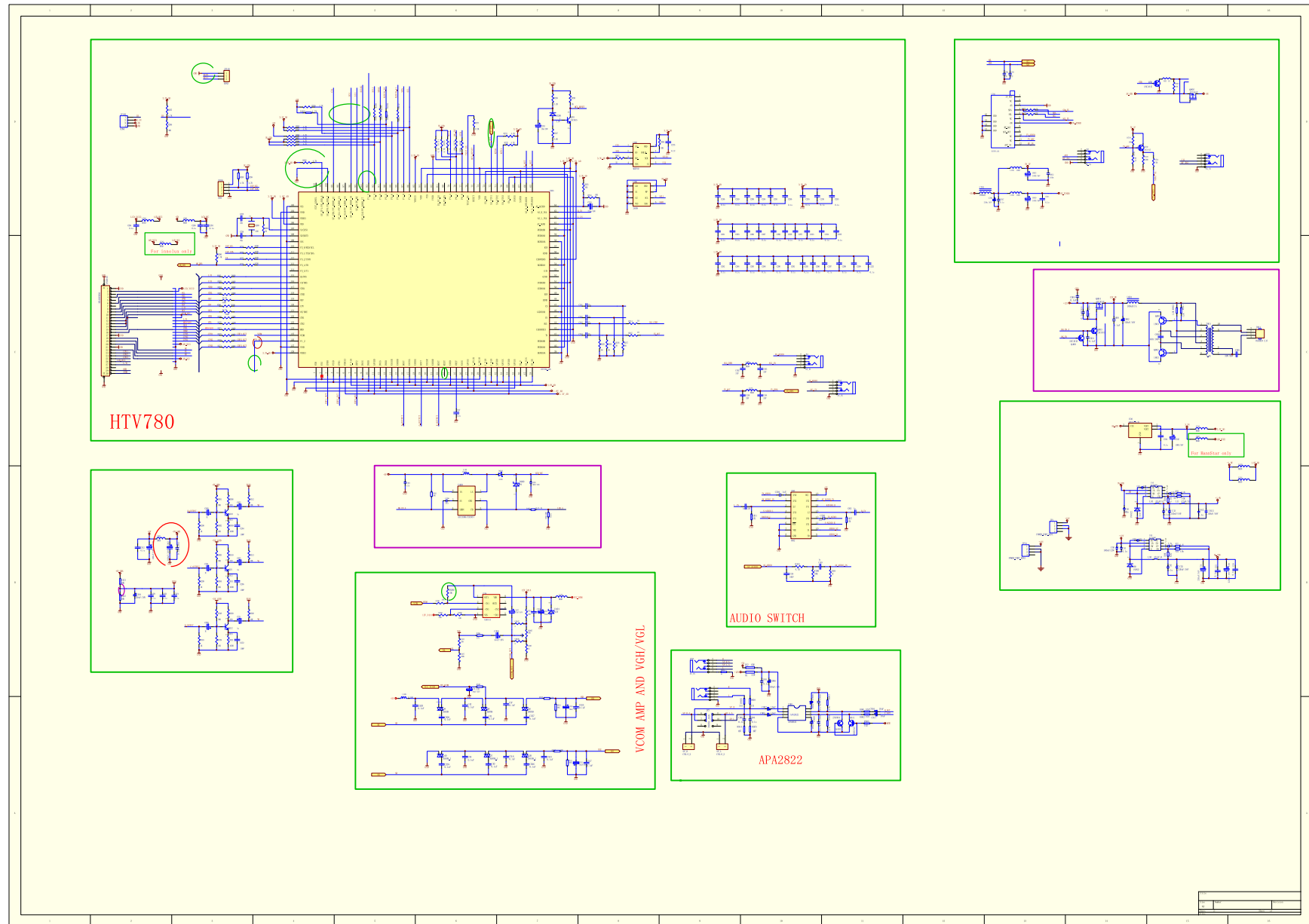

BLOCK DIAGRAM

BLOCK DIAGRAM

BLOCK DIAGRAM (DATE: 2007-06-08) :

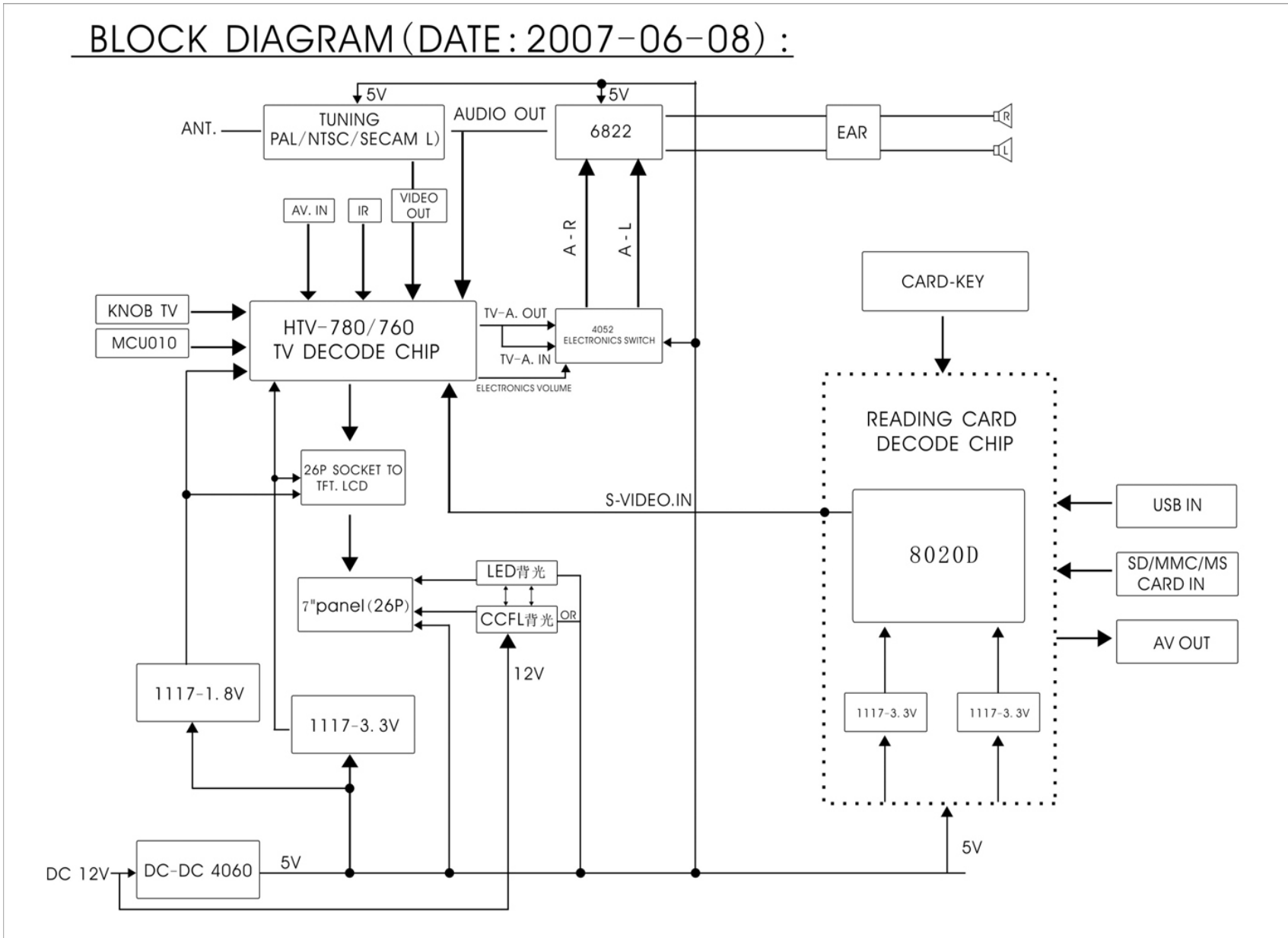

General Specification

1. Description: Portable 9" TFT LCD Color TV Set
2. TV System: NTSC(M)/PAL B/G D/K I PAL-M PAL-N(M)/SECAM B/G D/K / SECAM-L (Optional)
3. Audio System: M, B/G, D/K, I (Optional)
4. Display device: Color TFT-LCD
5. Display Screen Size: 9 inches
6. Video Input: 1Vp-p
7. Audio Output: $\geq 250\text{mW}$ (MAX)
8. Input Resistance : 75Ω
9. Power Consumption: $\leq 11\text{w}$
10. Resolution: 640 (H)*220 (V)
11. Dots Distance: 0.3165(H) X 0.4785(V)mm
12. Visible Range: 202.56(H) X 105.27(V)mm
13. Power Source: AC 100V-240V 50/60Hz DC 12V 1500mA or car adaptor
14. Measurement: 236(L) X 170 (W) X 28 (D) mm
15. Weight: Approx. 850g
16. Connection terminals:
 - a. Antenna Jack
 - b. AV Input Jack
 - c. Headphone Jack
 - d. External Power Source Input Jack